

2ML ELECTRONIC CGIARETTE

ADDICTIVENESS

This product contains nicotine which is a highly addictive substance. It is not recommended for non-smokers. This product may be hazardous to health. Keep out of children's and animals' reach. No other ingredients in this product, aside from nicotine, are known to be addictive.

THIS PRODUCT IS NOT SUITABLE FOR USE BY

1. Persons under 18 years of age
2. Individuals allergic or sensitive to nicotine or any other listed ingredient
3. Pregnant or breast-feeding women
4. Those who should avoid tobacco or nicotine products for medical reasons
5. Individuals with unstable heart conditions, severe hypertension, hepatic or renal failure, or diabetes

WARNING

This product is designed for use with various strengths of e-liquid. If you come into direct contact with the liquid, please wash your hands and forearms thoroughly. Exposure can be harmful if it gets into your eyes, flush them with water and seek medical attention. If swallowed, rinse your mouth and seek immediate medical help. When seeking medical advice, have the product container or label available. Do not use if you have an unstable heart condition, severe hypertension or diabetes.

KEEP OUT OF REACH OF CHILDREN

This product is intended for adult smokers only and is not recommended for non-smokers, individuals under 18, pregnant or breastfeeding women, those allergic to any listed ingredients, or people with general health issues. It contains nicotine, which may increase heart rate and blood pressure, and can cause nausea, dizziness, or worsen respiratory conditions. If you experience adverse reactions, contact your doctor and inform us via email. Do not use if the packaging is damaged.

STORAGE OF THE PRODUCT

Always keep the container fully closed and upright. Store the product at a temperature between 18-30, away from direct sunlight. Do not freeze, refrigerate, heat, or store it at temperatures above 30°C

PARAMETERS	PACKAGE LIST
E-liquid Capacity: 2ml+10ml	1x Electronic Cigarette (2ml)
Nicotine Strength: 20mg/ml	
Battery Capacity: 650 mAh	1x Refill Container (10ml)
Puffs: Around 10000	1x User Manual
1.0Ω Mesh Coil	

INSTRUCTIONS FOR USE

This product is pre-charged and ready to use.

1. Unpack the device.
2. Take out the silicone mouthpiece plug and fill it with oil.
3. Charge the device if the LED is continuously red.

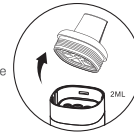

TOXICITY

This product contains nicotine which may produce toxic effects if consumed orally.



Manufactured by:
SHENZHEN IJOY TECHNOLOGY CO., LTD.
Address: 3rd Floor of Building 8, 301 and 302 of Building 10, 401 and 402 of Building 8, Hengmingzhu Science and Technology Industrial Park, Tongfuyu Industrial Park, Gonghe Community, Shajing street, Bao'an District, Shenzhen, China



10ML REFILL CONTAINER

ADDICTIVENESS

This product contains nicotine which is a highly addictive substance. It is not recommended for non-smokers. This product may be hazardous to health. Keep out of children's and animals' reach. No other ingredients in this product, aside from nicotine, are known to be addictive.

THIS PRODUCT IS NOT SUITABLE FOR USE BY

1. Persons under 18 years of age
2. Individuals allergic or sensitive to nicotine or any other listed ingredient
3. Pregnant or breast-feeding women
4. Those who should avoid tobacco or nicotine products for medical reasons
5. Individuals with unstable heart conditions, severe hypertension, hepatic or renal failure, or diabetes

WARNING

This product is designed for use with various strengths of e-liquid. If you come into direct contact with the liquid, please wash your hands and forearms thoroughly. Exposure can be harmful if it gets into your eyes, flush them with water and seek medical attention. If swallowed, rinse your mouth and seek immediate medical help. When seeking medical advice, have the product container or label available. Do not use if you have an unstable heart condition, severe hypertension or diabetes.

KEEP OUT OF REACH OF CHILDREN

This product is intended for adult smokers only and is not recommended for non-smokers, individuals under 18, pregnant or breastfeeding women, those allergic to any listed ingredients, or people with general health issues. It contains nicotine, which may increase heart rate and blood pressure, and can cause nausea, dizziness, or worsen respiratory conditions. If you experience adverse reactions, contact your doctor and inform us via email. Do not use if the packaging is damaged.

STORAGE OF THE PRODUCT

Always keep the container fully closed and upright. Store the product at a temperature between 18-30, away from direct sunlight. Do not freeze, refrigerate, heat, or store it at temperatures above 30°C

PARAMETERS	PACKAGE LIST
E-liquid Capacity: 2ml+10ml	1x Electronic Cigarette (2ml)
Nicotine Strength: 20mg/ml	
Battery Capacity: 650 mAh	1x Refill Container (10ml)
Puffs: Around 10000	1x User Manual
1.0Ω Mesh Coil	

INSTRUCTIONS FOR USE

This product is pre-charged and ready to use.

1. Unpack the oil container and remove the bottom sealing sleeve.
2. Fill the container with E-liquid through the two holes at the bottom.

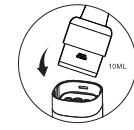

TOXICITY

This product contains nicotine which may produce toxic effects if consumed orally.



Manufactured by:
SHENZHEN IJOY TECHNOLOGY CO., LTD.
Address: 3rd Floor of Building 8, 301 and 302 of Building 10, 401 and 402 of Building 8, Hengmingzhu Science and Technology Industrial Park, Tongfuyu Industrial Park, Gonghe Community, Shajing street, Bao'an District, Shenzhen, China

